

Antfarm tree lot

- * Dates - Nov 30th - Dec 23rd unless we sell out of trees
- * Times open Thursday - Saturday 4-7pm
Monday - Wednesday by appointment
- * Electricity - using our own plug ins on the building. Running 3 strands of lights.
Non-blinking, twinkling or strobe.
- * 2 banners on our fences one on proctor side and one on Pioneer side.

Scales are

RECEIVED
DEC 06 2023

City of Sandy

MHFM Grounds

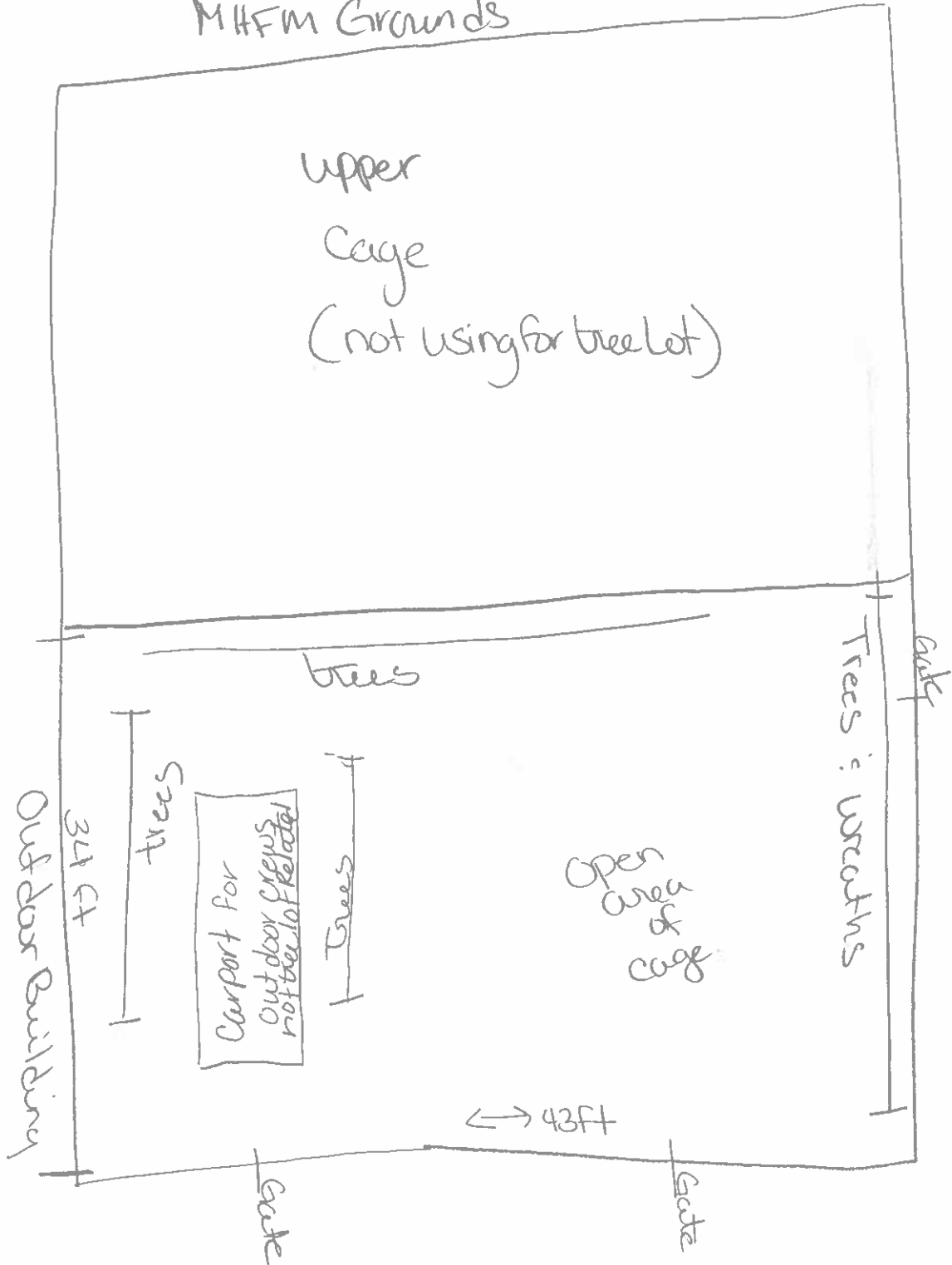

Pioneer Blvd